

Locomarine



YACHT ROUTER

SYSTEM EXAMPLES

SERIES 6

The easiest way to stay online.

Motor boat 45-75 ft

BASIC SYSTEM

COMPONENTS:

YACHT ROUTER MINI

DESCRIPTION:

System consist of Yacht Router Mini without any Add-on modules and without external antennas. Starlink satellite system is connected to two Internet sources are available to each of two Vessel Networks (e.g. Crew, Guests)

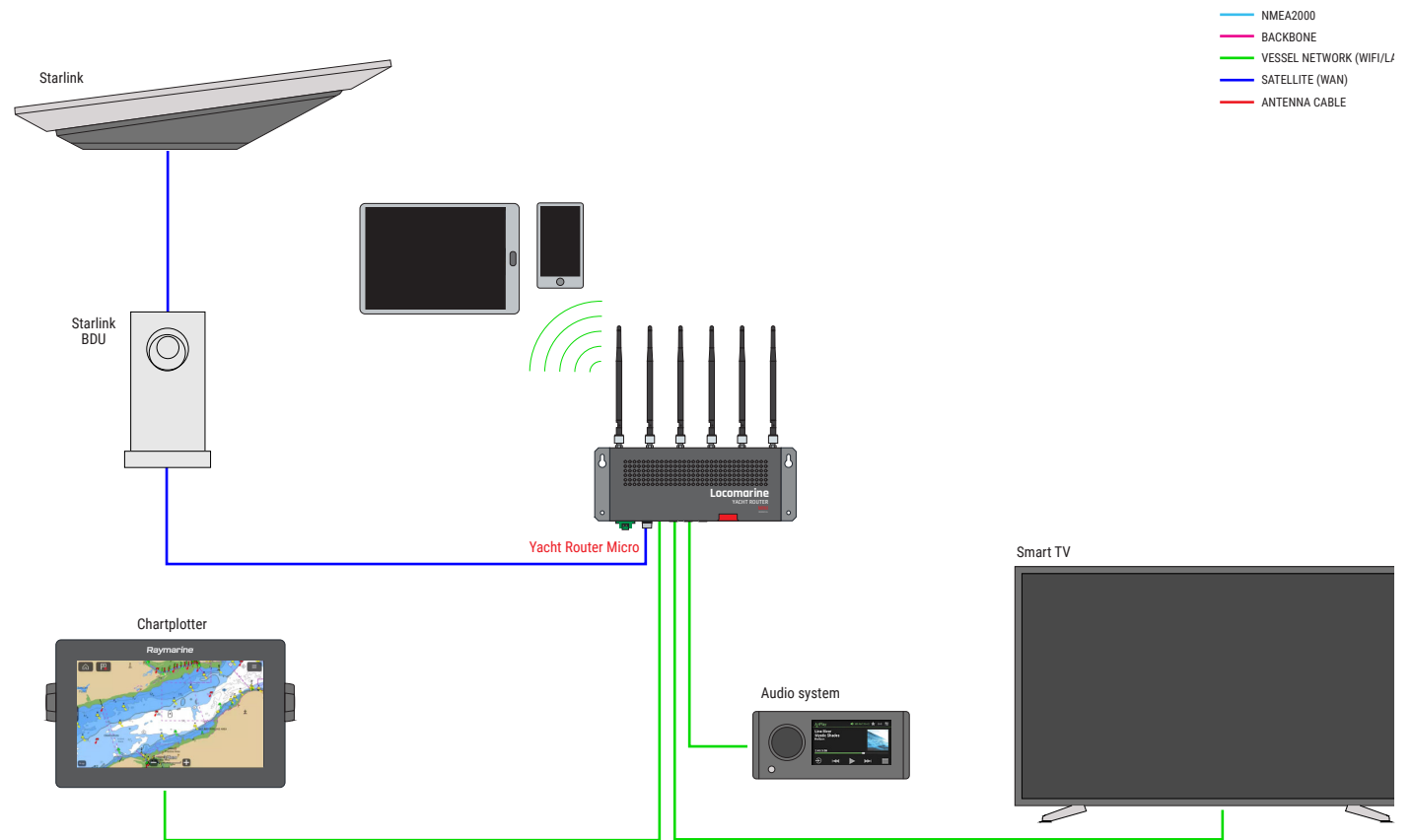

STANDARD SYSTEM

COMPONENTS:

YACHT ROUTER MINI
 NMEA2000 TO ETHERNET CONVERTER
 MID-GAIN EXTERNAL ANTENNA

DESCRIPTION:

This solution will provide NMEA data over WIFI/LAN as NMEA2000 to Ethernet Converter is connected. External mid-gain antenna will provide good offshore connectivity to 3G/4G/5G networks. Starlink satellite system is connected to two Internet sources are available to each of two Vessel Networks (e.g. Crew, Guests)

INSTALLATION TIPS:

External 3G/4G/5G antenna should be installed on deck level to minimize coax cable signal loss. Installation of antenna inside a boat is also possible but only if hull/deck is made of GRP.

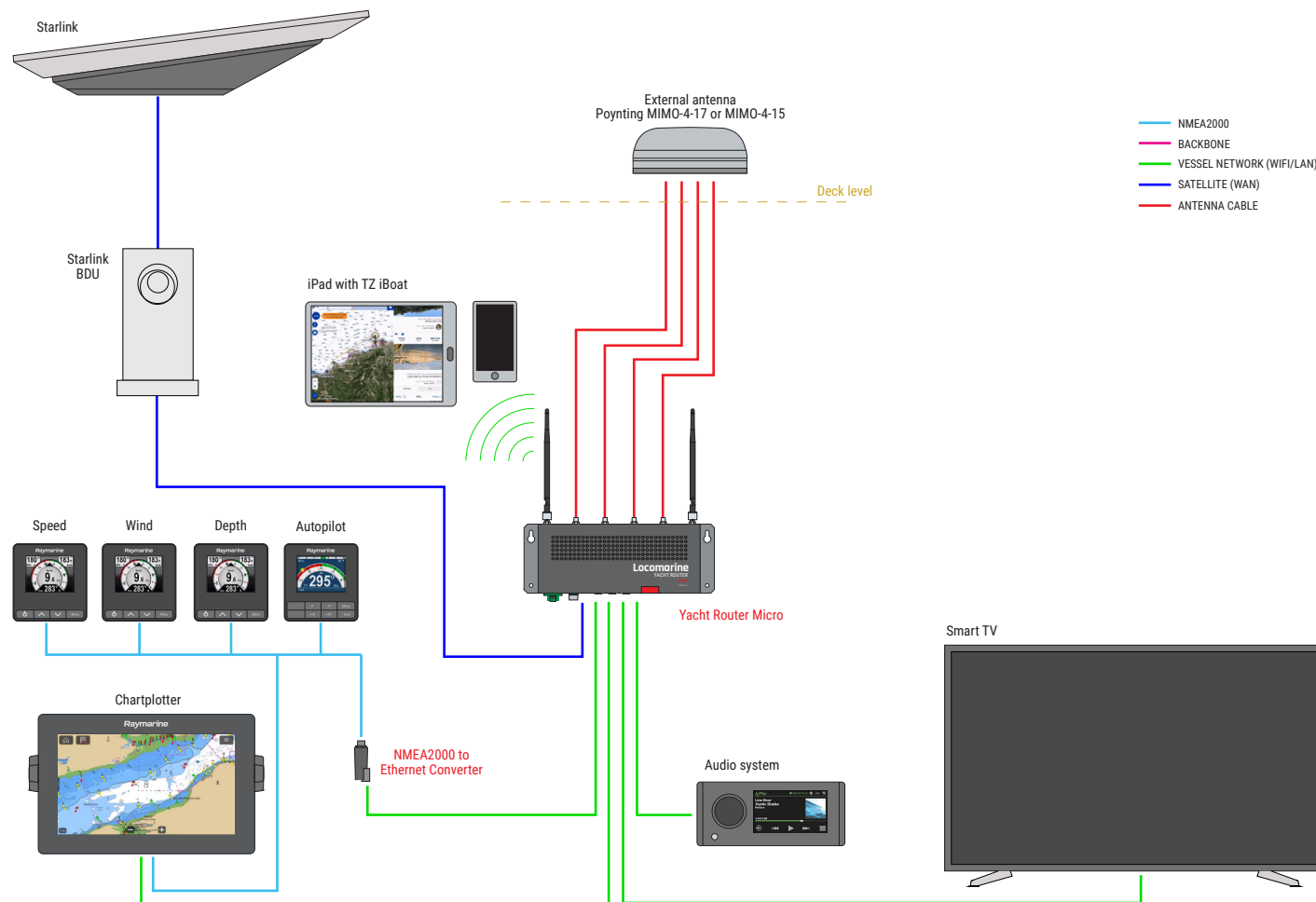

ADVANCED SYSTEM

COMPONENTS:

- YACHT ROUTER MINI
- NETWORK EXTENDER
- WIFI BOOSTER
- NMEA2000 TO ETHERNET CONVERTER
- MID-GAIN EXTERNAL ANTENNA

DESCRIPTION:

This solution will provide NMEA data over WIFI/LAN as NMEA2000 to Ethernet Converter is connected. As WIFI Booster is connected, Yacht Router will be able to connect to shore WIFI (e.g. Hotspot in marine, restaurants etc). As this is larger boat additional Network Extender is connected to cover all cabins with good WIFI signal. External mid-gain antenna will provide better offshore connectivity to 3G/4G/5G networks. Starlink satellite system is connected to two Internet sources are available to each of two Vessel Networks (e.g. Crew, Guests)

INSTALLATION TIPS:

External 3G/4G/5G antenna should be installed on deck level to minimize coax cable signal loss. Installation of antenna inside a boat is also possible but only if hull/deck is made of GRP.

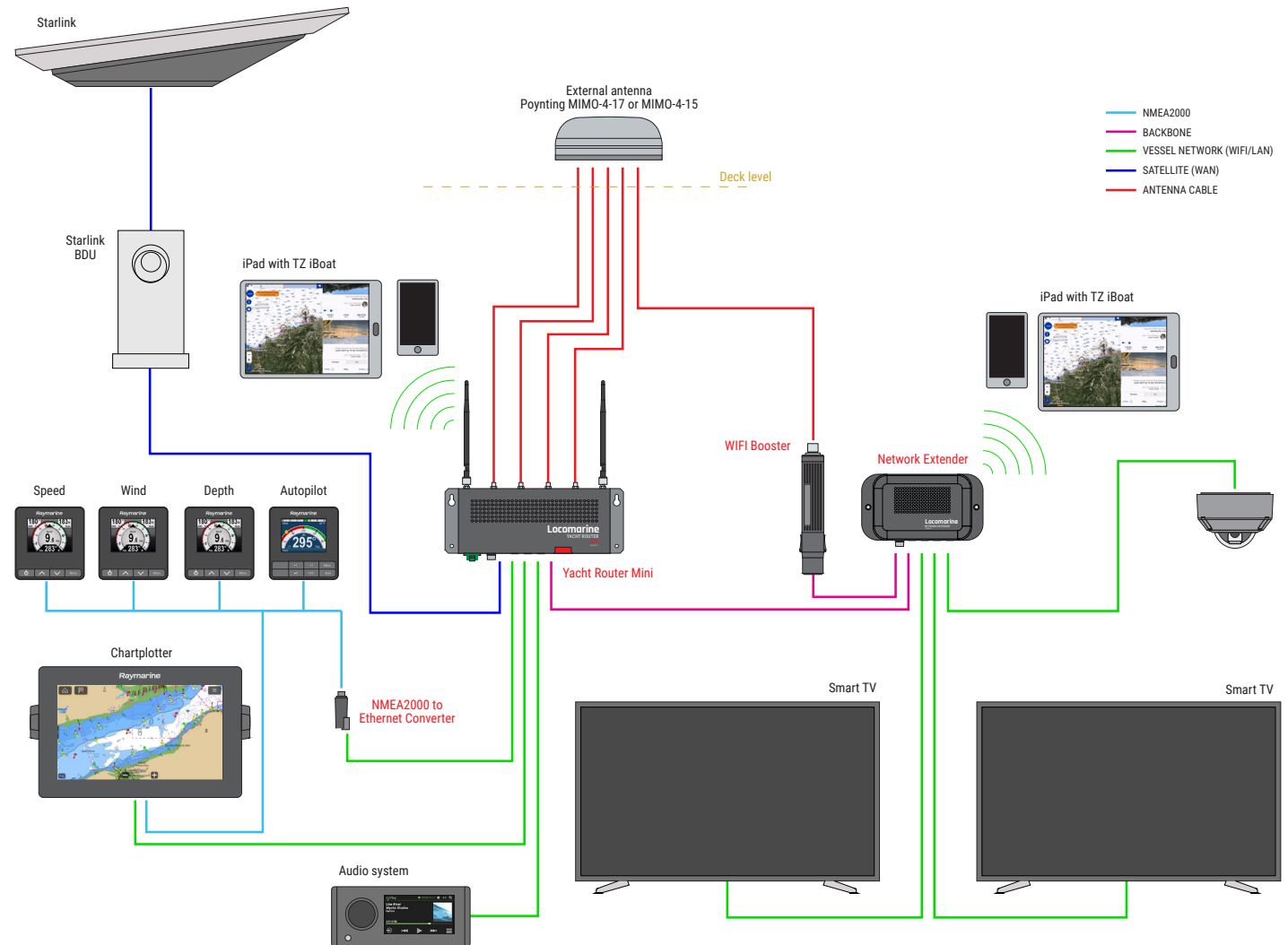

ADVANCED OFFSHORE SYSTEM

COMPONENTS:

- YACHT ROUTER MINI
- NETWORK EXTENDER
- WIFI BOOSTER
- NMEA2000 TO ETHERNET CONVERTER
- MID-GAIN EXTERNAL ANTENNA

DESCRIPTION:

This solution will provide NMEA data over WIFI/LAN as NMEA2000 to Ethernet Converter is connected. As WIFI Booster is connected, Yacht Router will be able to connect to shore WIFI (e.g. Hotspot in marine, restaurants etc). As this is larger boat additional Network Extender is connected to cover all cabins with good WIFI signal. External high-gain antenna will provide super long-distance offshore connectivity to 3G/4G/5G networks, in ideal conditions up to 30+ NM offshore. Starlink satellite system is connected to two Internet sources are available to each of two Vessel Networks (e.g. Crew, Guests)

INSTALLATION TIPS:

External 3G/4G/5G antennas should be installed on a first spreader with minimum horizontal separation of 60 cm. It is important to keep antenna cables as short as possible to minimize signal loss. We strongly recommend high-quality coax cables like LMR240 or LMR400. Where router-antenna distance is less than 10 m we recommend LMR240 and for longer distances LMR400 or cables with similar specifications.

As WIFI Booster is waterproof PoE device, installation on spreader is possible with dedicated spreader mount.

